



FUEL LINES

& FITTINGS



FUEL LINE & FITTINGS

CONTENTS

FUELLINE & FITTINGS

NYLON FUEL LINES

..... 2-2

COMPRESSION UNIONS

Nylon to Nylon 2-2

Nylon to Steel 2-2

360° Seal Unions 2-2

FITTINGS

Splice Joiners 2-2

GM Fuel Sender Adapters 2-2

Viton O-Rings 2-2

FUEL LINE ADAPTERS

..... 2-3

STEEL REPAIR LINES

..... 2-3

CLAMPS

Oetker360° 2-3

Fuel Injector..... 2-3

CONNECTORS

Quick Disconnect—Straight..... 2-4

Quick Disconnect—90° Bend 2-4

FUEL LINE RETAINER CLIPS

..... 2-4

TOOLS

Quick Disconnect Retainer Removal Tool.. 2-4

Fuel Line Quick Assembly Tool 2-5

ASSORTMENTS

..... 2-5

FUEL LINES & FITTINGS

FITTINGS

Nylon Fuel Lines

Part No.	Tube	Length	Pkg Qty.
FL-14	1/4"	25'	1
FL-56	5/16"	25'	1
FL-38	3/8"	25'	1



Compression Unions

Part No.	Thread Size	Pkg Qty.
Nylon to Nylon		
BR-62CNN	1/4"	2
BR-62DNN	5/16"	2
BR-62ENN	3/8"	2
Nylon to Steel		
BR-62CNS	1/4"	2
BR-62DNS	5/16"	2
BR-62ENS	3/8"	2



360° Seal Compression Unions

For Steel/Nylon/Copper/Aluminum Tubing

Part No.	Thread Size	Pkg Qty.
Reducing		
BR-2841	3/8" to 5/16"	2
BR-2842	10mm to 3/8"	2
Straight		
BR-2856	1/4"	2
BR-2857	5/16"	2
BR-2858	3/8"	2
90° Elbow		
BR-2846	5/16"	2
BR-2847	3/8"	2



Splice Joiners

Part No.	Thread Size	Pkg Qty.
For Nylon Fuel Line		
BB-14	1/4"	5
BB-516	5/16"	5
BB-38	3/8"	5
For Rubber Fuel Line		
BFC-4	1/4"	5
BFC-5	5/16"	5
BFC-6	3/8"	5



GM Fuel Sender Adapters

Part No.	Thread Size	Male Connection	Pkg Qty.
To Rubber Fuel Line			
FH-14	14mm	5/16"	5
FH-16	16mm	3/8"	5
To Nylon Fuel Line			
FS-14	14mm	5/16"	5
FS-16	16mm	3/8"	5



Viton O-Rings

Part No.	Line Size	Pkg Qty.
OR-38	3/8"	10
OR-516	5/16"	10



FUEL LINES & FITTINGS

FUEL LINE ADAPTERS

Quick Connector Fuel Line

Part No.	Female Connection	Male Connection	Pkg Qty.
Quick Connect to Steel to Nylon			
AL-102B	5/16"	5/16"	2
AL-103B	3/8"	3/8"	2
GM to Nylon or Rubber			
AL-104B	14mm	5/16"	2
AL-105B	16mm	3/8"	2

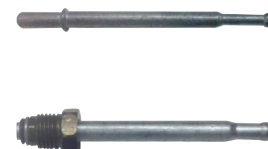

Fuel Sending Unit Repair Line

Part No.	Line Size	Length	Pkg Qty.
180° Fuel Filter Repair Line with 16mm GM Fitting			
FL-6188B	3/8"	6-1/2"	2



Steel Repair Lines

Part No.	Line Size	Length	Pkg Qty.
14mm with Fitting & O-Ring			
FL-510B	5/16"	9"	2
FL-518B	5/16"	18"	2
FL-536B	5/16"	36"	2
16mm with Fitting & O-Ring			
FL-610B	3/8"	9"	2
FL-618B	3/8"	18"	2
FL-636B	3/8"	36"	2



Fuel Line Clamps

Part No.	Tube Size	Pkg Qty.
Oetker360° for Nylon & Rubber Hose		
CSO-14	9/32"	10
CSO-56	3/8"	10
CSO-38	7/16"	10
Fuel Injection Clamps		
HCM-4F	1/4"	10
HCM-6F	5/16"	10
HCM-8F	3/8"	10



FUEL LINES & FITTINGS

CONNECTORS

Part No.	Female Connection	Male Connection	Pkg Qty.
Straight - Quick Disconnect			
TCS-58	5/16"	5/16"	2
TCS-68	3/8"	5/16"	2
TCS-510	5/16"	3/8"	2
TCS-610	3/8"	3/8"	2
90° Bend - Quick Disconnect			
TCB-58	5/16"	5/16"	2
TCB-68	3/8"	5/16"	2
TCB-510	5/16"	3/8"	2
TCB-610	3/8"	3/8"	2



Steel & Nylon Quick Connector Fuel Line Retainer Clips



CL-102B



CL-103B



CL-104B



CL-105B

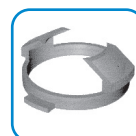

CL-106B

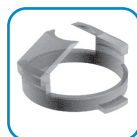

CL-110B



CL-120B



CL-121B

Part No.	Size	Description	Pkg Qty.
CL-102B	3/8"	GM, Chrysler, Ford	10
CL-103B	5/16"	GM, Chrysler, Ford	10
CL-104B	5/16"	Ford (White)	10
CL-105B	3/8"	Ford (Black)	10
CL-106B	1/4"	Ford	10
CL-110B	1/2"	Ford	10
CL-120B	5/16"	Ford (White)	10
CL-121B	3/8"	Ford (Black)	10

QUICK DISCONNECT RETAINER REMOVAL TOOL

For 5/16" & 3/8"

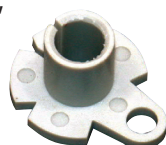

No. DT-1B

FUEL LINES & FITTINGS

DYNAMIC - FUEL LINE FITTINGS ASSORTMENT

Dynamic Fuel Fittings Assortment contains all of the popular fittings needed to replace fuel line connectors on both steel and nylon line. Assortment includes quick connectors (straight and 90°), brass connectors, compression unions, clamps, O-rings, and connector removal tool.

Each assortment comes in a durable plastic case that keeps all of the fittings organized and easy to find. The detailed lid insert identifies each fitting with a graphic reference and size. Reorder part numbers, quantities and UPC codes are also shown.

Available Assortments:

See Automotive Service Parts Assortment Catalog for specific part numbers and quantities



Fuel Line Repair Parts Assortment No. DY-FLA-2

Connectors, fitting and clamps for fuel line repair.

- 24 part numbers
- 86 total pieces