



DY-BLE-E



DY-BLE-R
Repeater
(Optional Add-On)

EXTERNAL BLUETOOTH LOW-ENERGY (BLE) TIRE MONITORING SYSTEM USER'S MANUAL

Part No. DY-BLE-E

FOR WARRANTY INFORMATION, PLEASE CALL 800-433-0708

DATE OF PURCHASE: _____

READ AND SAVE THIS MANUAL

FOR SERVICE ASSISTANCE, CALL 800-433-0708 OR VISIT JOHNDOW.COM



Important Safety Information

Read this manual and safety information before using these sensors.

WARNING

Indicates a hazardous situation that, if not avoided, could result in minor or moderate injury.

FCC Radiation Exposure Statement

This equipment complies with FCC RF radiation exposure limits set forth for an uncontrolled environment. Install and operate this equipment with a minimum distance of 0.5 centimeters between the radiator and your body.

This transmitter must not be co-located or operating in conjunction with any other antenna or transmitter.

The antennas used for this transmitter must be installed to provide a separation distance of at least 0.5 cm from all persons and must not be co-located or operating in conjunction with any other antenna or transmitter.

This device complies with Part 15 of the FCC Rules. Operation is subject to the following two conditions:

- (1) This device may not cause harmful interference, and
- (2) This device must accept any interference received, including interference that may cause undesired operation.

Federal Communication – Commission Interference Statement

This equipment has been tested and found to comply with the limits for a Class B digital device, pursuant to Part 15 of the FCC Rules. These limits are designed to provide reasonable protection against harmful interference in a residential installation.

This equipment generates, uses and can radiate radio frequency energy and, if not installed and used in accordance with the instructions, may cause harmful interference to radio communications. However, there is no guarantee that interference will not occur in a particular installation. If this equipment does cause harmful interference to radio or television reception, which can be determined by turning the equipment off and on, the user is encouraged to try to correct the interference by one of the following measures:

- Reorient or relocate the receiving antenna.
- Increase the separation between the equipment and receiver.
- Connect the equipment into an outlet on a circuit different from that to which the receiver is connected.
- Consult the dealer or an experienced radio/TV technician for help.

FCC Caution: To assure continued compliance, any changes or modifications not expressly approved by the party responsible for compliance could void the user's authority to operate this equipment (Example - use only shielded interface cables when connecting to computer or peripheral devices).

DY-BLE-E SPECIFICATIONS

Operating Voltage	1.8V/3.6V	Monitored Pressure Range	0 ~ 185 PSI (0 to 1280kPa)
Operating Humidity	95% MAX	Monitored Temperature Range	-40°F to 221°F
Operating Current	< 18mA	Operating Frequency	2.4 GHz
Storage Temperature	-40°F ~ 257°F	Transmission Power	8dBm MAX
Operating Temperature	-4°F ~ 221°F	Battery Life	3 ~ 5 Years

NOTE: NOT INTENDED TO SUBMERGE IN WATER. FOR METAL VALVES ONLY.

Please refer to the BLE TPMS Sensor User Guide for pairing instructions.

1. Scan your device's QR Code:



Android



iOS

We highly recommend replacing any rubber valve stems with brass/stainless steel stems.

Make sure to inspect all of your current valve stems and replace any cracked or damaged valve stems before installing these external tire pressure sensors.

Optional Anti-Theft Lock Nut

Tools & Supplies Needed (Sold separately)

Anti-Theft Lock Nut

Wrench

ASSEMBLY INSTRUCTIONS FOR ANTI-THEFT LOCK NUT

1. Screw down the lock-nut on the tire valve stem (Figure 1). Tighten by hand ONLY.
2. Tightly screw the sensor on the tire valve stem until you no longer hear air escaping from the tire valve (Figure 2).
3. Apply soapy water on the valve stem and lock nut. If bubbles appear, re-install the lock nut and sensor. If no bubbles appear, installation is successful (Figure 3).

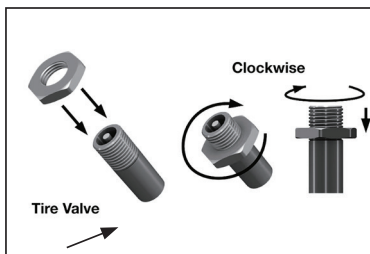

Figure 1

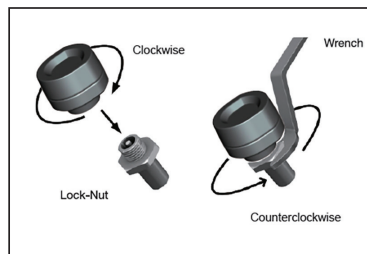

Figure 2

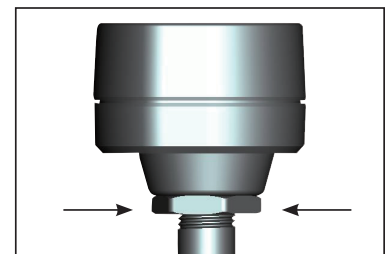

Figure 3

FOR SERVICE ASSISTANCE, CALL 800-433-0708 OR VISIT JOHNDOW.COM

DY-BLE-R SPECIFICATIONS

Operating Voltage	12V/24V
Operating Humidity	90% MAX
Storage Temperature	-40°F ~ 494.6°F
Operating Temperature	-4°F ~ 185°F
Operating Frequency	Bluetooth Low Energy 4.0, 2400MHz-2483.5MHz

Transmission Power	4dBm MAX
Receiver Sensitivity	< -85dBm
Operating Current	40mA MAX @ DC12V
Waterproof	IP67
Battery Life	3 ~ 5 Years

REPEATER ASSEMBLY INSTRUCTIONS

1. You can mount the repeater anywhere outside of the vehicle as it is weather-resistant (Figure 4).
2. Do not directly connect to the storage battery.

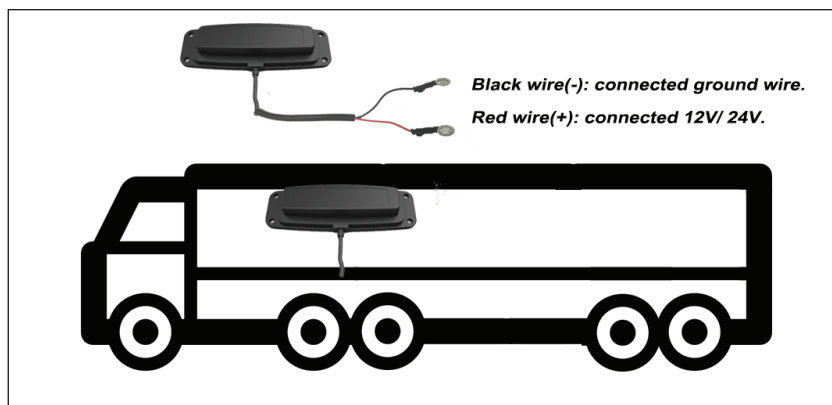

Figure 4

WARRANTY

The warranty is good for one year from the date of purchase. We will replace the sensors during this warranty period upon meeting the following conditions:

1. Confirm purchase date and cause of defect.
2. Sensors are installed and used correctly, as indicated in this manual, and BLE TPMS User Guide.
3. You did not disassemble the sensors.
4. The main cause of product failure is due to manufacturing issues.

Disclaimer:

The warranty applies to the original purchaser only. Please follow the standard installation procedures. Before using, the user shall determine the suitability of the product for its intended use. If the electrical installation and failure is caused by improper use, the company is not responsible for any civil or criminal liabilities.